

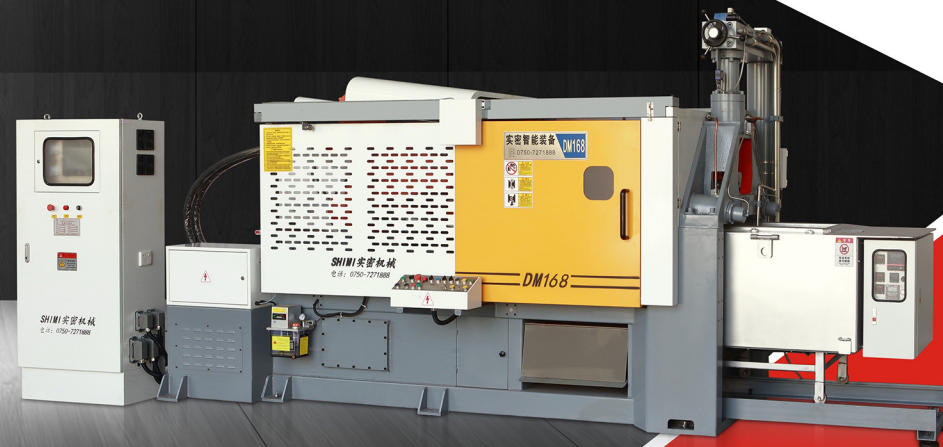

我们的使命:以务实创新助力中国精密装备领先全球

Our mission: To help China's precision equipment lead the world with practical innovation

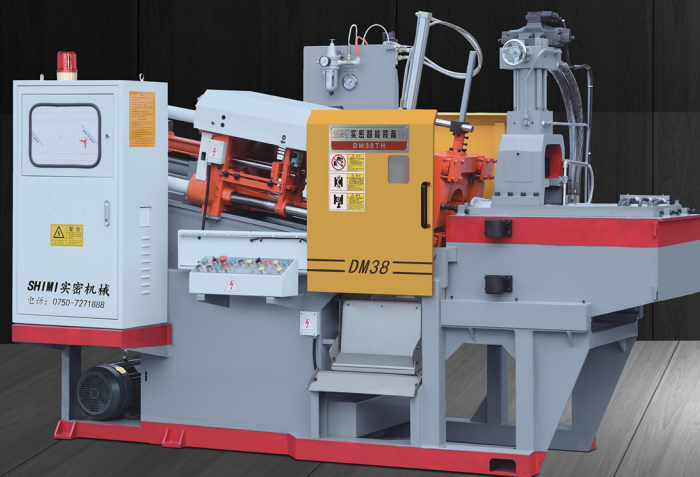

广东实密智能装备有限公司

Guangdong Shimi Intelligent Equipment Co., Ltd

广东省江门市恩平市大槐镇建设路11-1号

Add: No. 11-1, Jianshe Road, Dahuai Town, Enping City, Jiangmen City, Guangdong Province China

+86-0750-7271888 +86-0750-7273399

+86-13822780698

shimi@shimidcm.com

www.shimidcm.com

二维码QR code:



微官网

官网二维码(中文)

QR Code of Official website
(English edition)

SHIMI DIE-CASTING MACHINE

Create more efficient, energy-saving, stable and durable die-casting machines

打造更高效·节能·稳定·耐用的压铸机

www.shimidcm.com

广东实密智能装备有限公司

Guangdong Shimi Intelligent Equipment Co., Ltd



COMPANY PROFILE 公司简介

广东实密智能装备有限公司是一家专业从事研发、制造、销售和出口冷室、热室、立式等压铸机的生产制造企业。公司自2009年成立以来，依靠专业的研发团队，结合国内外先进的压铸机生产工艺，自主研发生产出数百种具有高性能、高稳定性的可靠产品，时刻走在行业技术的前端，从而实现了公司的快速发展，并于2022年在广东江门投资新建生产基地，占地面积2.3万平方米。

实密，拥有生产大型压铸机的研发和制造能力，通过高精密的加工设备、行业顶尖的检测仪器、严谨的装配技术以及国际知名的压铸机元件，全面提升了产品的整体水平和核心竞争力，从原材料、机加工、焊接、组装、调试、到最终检验，拥有完善、科学的生产及检验体系。

每一台压铸机在出厂前的最终检验时间超过72个小时，确保每个细节做到极致，在保证机器稳定耐用的前提下打造出更高效节能的压铸机产品。

Guangdong ShiMi Intelligent Equipment Co., Ltd. is a professional manufacturing enterprise engaged in research and development, manufacturing, sales and export of cold and hot chamber die-casting machines, vertical die-casting machines and semi-solid die-casting machines. Since founded in 2009, relying on professional R&D team, combining with advanced die-casting machine manufacturing process at home and abroad, ShiMi independently researched and developed hundred types of high-performance, high-stability and reliable machines, by staying ahead in this industry, making company have a rapid development, and it has invested in a new production base in Jiangmen, Guangdong in 2022, covering an area of 23000 square meters.

ShiMi has the capabilities of R&D and manufacturing to produce Heavy Type die casting machines, through the high-precision processing equipment, top-notch testing instruments in the industry, rigorous assembly technology and international well-known components, ensuring the overall level of machines and core competitiveness. From raw materials, machining, welding, assembly, commissioning to final inspection, ShiMi has complete production and quality control system.

The final inspection time of each die casting machine is more than 72 hours before leave factory, to ensure that every detail to be the utmost, to create more efficient, energy-saving die-casting machines under precondition of stability and durability of machines.



GLOBAL ENJOY FIVE-STAR SERVICE 全球享受·五星服务

售前服务 PRE-SALE SERVICE 1

我们免费为用户提供压铸一站式解决方案，从车间布局、产品选型、模具设计、压铸工艺到全自动周边辅助设备。

We provide customers with one-stop solution for free of charge, from workshop layout, selection of machine models, die design, die casting process, full automatic peripherals to further machining after die-casting.

售中服务 IN-SALES SERVICE 2

提供各种型号之压铸机销售、安装、调试及试生产服务、介绍、培训中高级压铸人才。

To recommend and provide professional talents in aspect of sales, installation, commissioning and trial-production for various models of die-casting machine.

售后服务 AFTER-SALE SERVICE 3

实密在国内以数十个省市为支点，建立了周全的国内销售服务网络，在海外，实密在全球多个国家拥有销售和售后服务网点，本着“及时响应，专业透明”的售后理念，赢得了海内外众多客户的广泛好评。

With dozens of provinces and cities as the fulcrum in China, we have established a comprehensive domestic sales and service network. We have sales and after-sales service outlets in many countries around the world as well. With the after-sales concept of "Timely response, professional and transparent", ShiMi has been widely praised from large numbers of customers at home and abroad.

研发专利 R & D PATENTS 4



热室系列 DM90T-DM400T

Hot Chamber Die Casting Machine Series DM90T - DM400T

- 1、采用快速差动再生锁模油路系统，开锁模动作运行平稳快速，提高生产效。
- 2、标配液压抽芯阀动型板1组。
- 3、台达和欧姆龙控制系统，威纶触摸屏，方便操控，丰富的各项功能页面，满足压铸工艺的调控。
- 4、强大参数储存功能，方便以后生产调用，提高生产效率，保持产品质量一致。
- 5、机身线路采用耐油耐温且外包钢丝护网电线，即使在恶劣的环境都很好防护，保证正常生产。

- 1, Adopt the fast differential regeneration mold-clamping hydraulic system, the movement of mold clamping/open runs smoothly and quickly, improving the production efficiency .
- 2, Standard hydraulic core-pulling valve is one group to movable die platen.
- 3, Delta and Omron control system, Weinview touch screen, easy to operation, substantial functional pages to meet the die-casting process control.
- 4, Powerful parameter storage function, convenient for production calls, improve production efficiency , keep product quality consistent.
- 5, The fuselage line is oil-resistant and heat-resistant and covered with steel wire mesh, for very good protection even in the harsh environment , ensure normal production.

新一代锌合金压铸机/高效/高精度/高稳定性

New Generation Zinc alloy die casting machine/high efficiency/high precision/high stability

实密热室压铸机被广泛应用于卫浴、服装、箱包、运动器材、五金饰品、电工电子、儿童玩具、汽配件、家居、航空航天等众多五金制品行业中。
ShiMi Hot Chamber Machines are widely used to sanitary ware, clothing, bags, sport equipment, hardware jewelry, Electrical and electronic, Children's toys, fishing, home appliances, aerospace and many other hardware products.

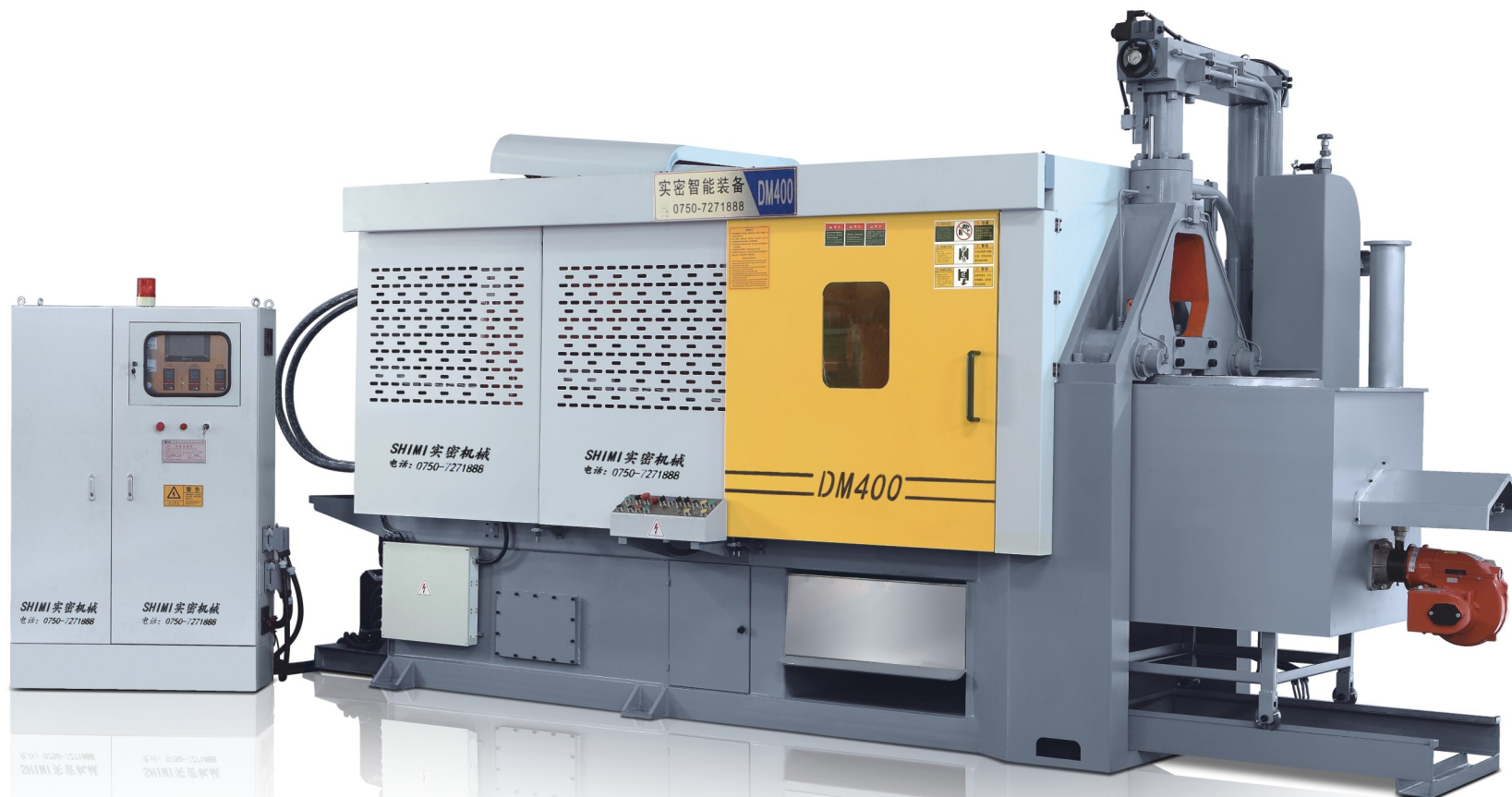

全新一代锌合金压铸机

New Generation Zinc Alloy Die-casting Machine

- 1、不锈钢锌锅:不锈钢锌锅相比普通不锈钢锌锅,抗腐蚀能力强,更经久耐用。
- 2、主要电气元件:电控部分配置施耐德和欧姆龙电气元件、欧姆龙PLC、威纶显示屏。
- 3、液压控制阀:液压控制主要配置德国力士乐油阀和台湾油研阀和油泵。

1. Stainless steel Pot for zinc : strong corrosion resistance, more durable .
2. main electrical components: electronic control parts are Schneider and Omron electrical components. Omron PLC and Weinview display.
3. Hydraulic Control Valve and Oil Pump : Rexroth Germany and Yuken Japan

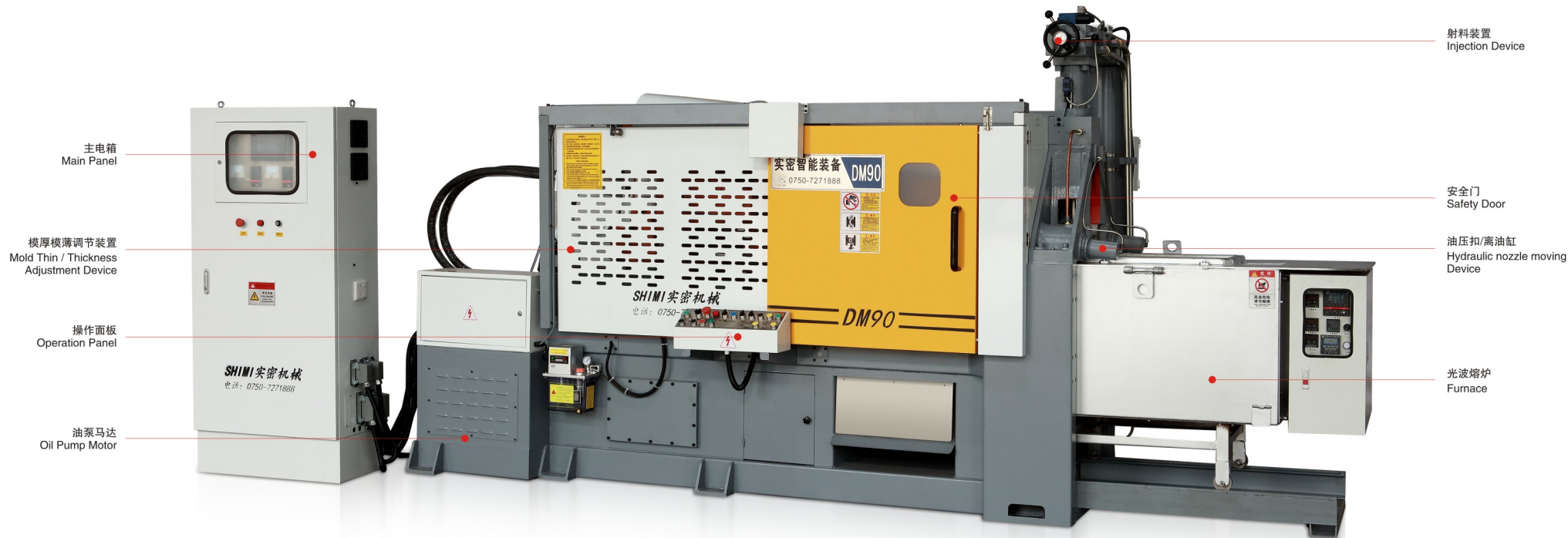

- 4、自动停泵:机器运转在一段(时间可自行设定)内无动作时,电机油泵会停止运转,减少电量和油泵损耗(如:机器试压模、修模操作人员未按急停按钮或机器长时间报警 时,超过设定时间,电机油泵会自动停止工作),主要为了减少安全事故发生。
- 5、自动泄压:机器出现故障急停时,系统压力自动泄压(避免机器长时间停机或故障报警急停时,机器处于高压状态,可延长油封使用寿命及减少安全事故的发生),主要为了减少安全事故发生,
- 6、整机密封件:密封件选用进口油封。

- 4, Automatic Pump Stop : The machine has no action in a period of time (time can be set), the motor pump will stop running, reduce the power and oil pump loss. (such as mold trail, mold repairman did not press the emergency stop button or the machine alarm for a long time , over the set time, the motor oil pump will automatically stop working), mainly aim to reduce the occurrence of safety accidents.
- 5, Automatic pressure release : when emergency stop due to failure of machine, the system pressure automatic releasing, (to avoid machine under mode of high pressure for long time when machine stop or Emergency stop due to failure of machine, to prolong the service life of oil seals), mainly aim to reduce the occurrence of safety accidents.
- 6, Seal elements of whole machine : seal elements are imported from abroad.

热室系列-快速料杯机DM25T

Hot Chamber Series - Fast Cup Type Machine DM 25T

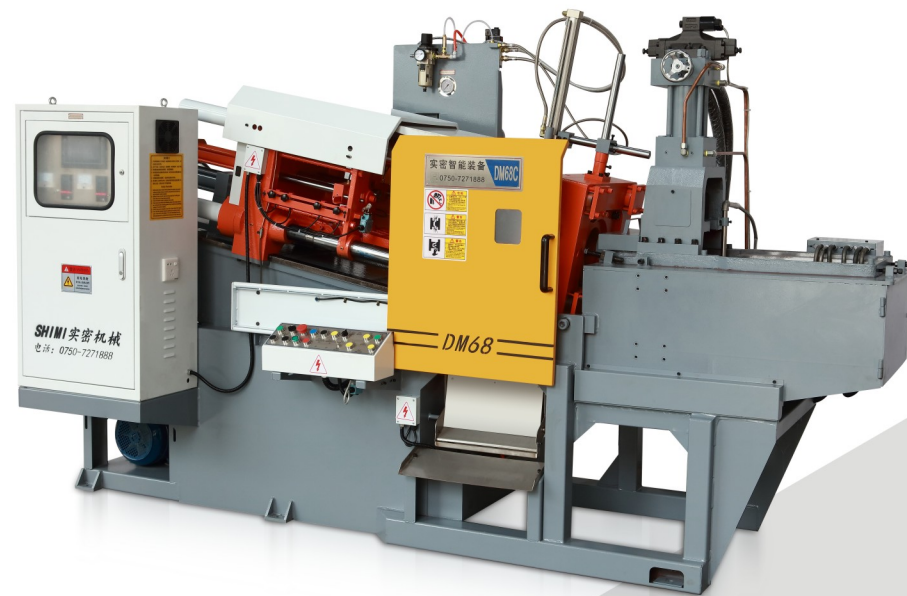
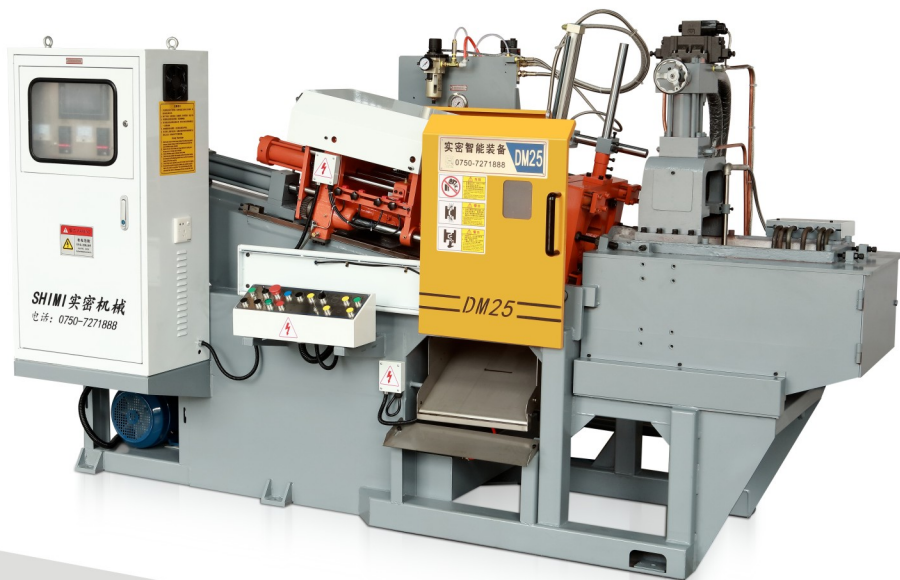

热室系列-快速料杯机DM68

Hot Chamber Series - Fast Cup Type Machine DM 68T



热室系列-快速料壶机DM30T

Hot Chamber Series - Fast Pot Type Machine DM 30T

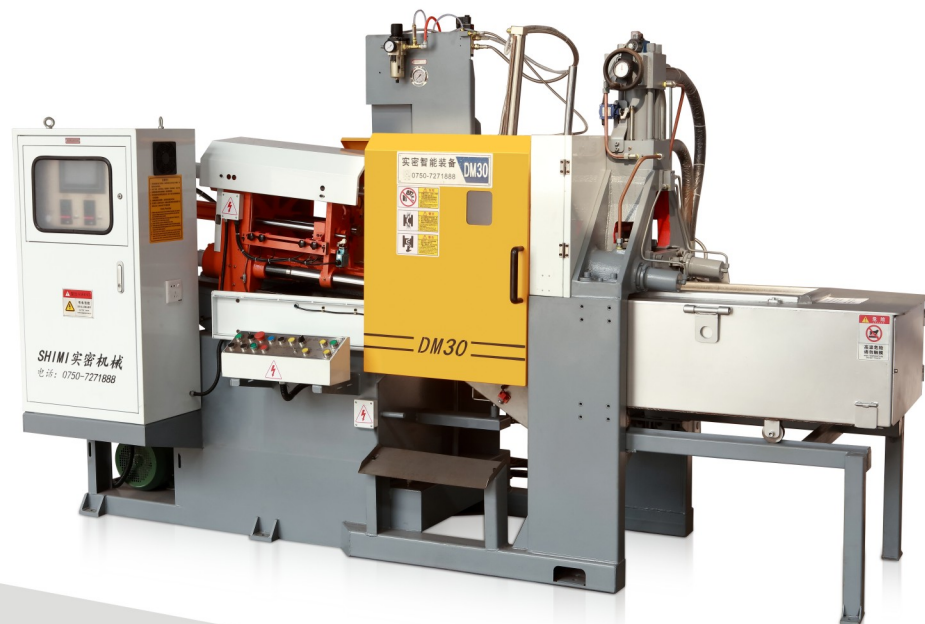
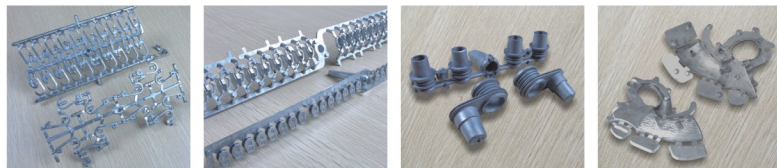

热室系列-快速料壶机DM50T

Hot Chamber Series - Fast Pot Type Machine DM 50T

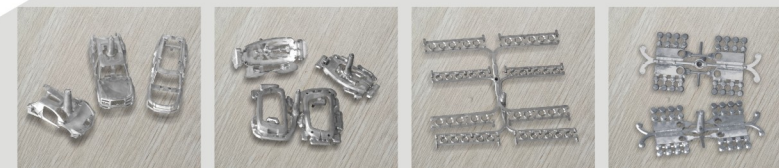

无阻高速精密锌合金压铸机DM25T-DM90T

High Speed Precision Zinc Alloy Die Casting Machine DM25T-DM90T (Products Without Sprue)

性能

Performance

- 1、压铸机和模具设计从产品分型面进料铸造，使其在压铸过程中进料更顺畅，料损耗更小。
 - 2、设备运行状态高速、精密、稳定，生产循环周期小于3秒。
 - 3、操作系统配置施耐德和欧姆龙电器元件和PLC，控制精准，操作简单。
1. The die casting machine and mold are designed to feed and cast from the parting surface of the product, so that the feeding is more smoother and the material loss is lower in the die-casting process.
2. The operation status of equipment is high-speed, precise and stable, and one production cycle is even less than 3 seconds.
3. The operating system is Schneider and Omron electrical components and PLC, with accurate control and simple operation.



立式高性能热室系列 DM25T -DM68T

High Performance Vertical Hot Chamber Die Casting Machine Series DM25T - DM68T

产品应用

Product applications

实密热室压铸机被广泛应用于卫浴、服装、箱包、运动器材、五金饰品、电工电子、儿童玩具、渔具、家居、航空航天等众多五金制品行业中。
ShiMi Hot Chamber Machines are widely used to sanitary ware, clothing, bags, sport equipment, hardware jewelry, Electrical and electronic, Children's toys, fishing, home appliances, aerospace and many other hardware products.

产品展示

Product display



锌合金热室机自动化生产线相关配置

Automation Production Line of Zinc Alloy Hot Chamber Die Casting Machines



产品输送带
Product conveyor belt



产品自动滚筒
Product Automatic Roller

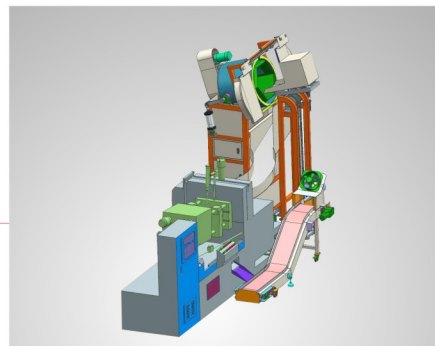

单机自动化滚筒1
Single Machine Automatic Drum 1



单机自动化滚筒2
Single Machine Automatic Drum 2



超声波分离机
Ultrasonic separator



取件喷雾一体机
pick-up spray integrated machine

料口集中回收输送线
The material feeding centralized recovery conveyor line

中央熔炉
The central furnace



料口回收输送线
Feed Inlet recovery conveyor line

横梁型或管道型加料线
Beam type or pipe type feeding line

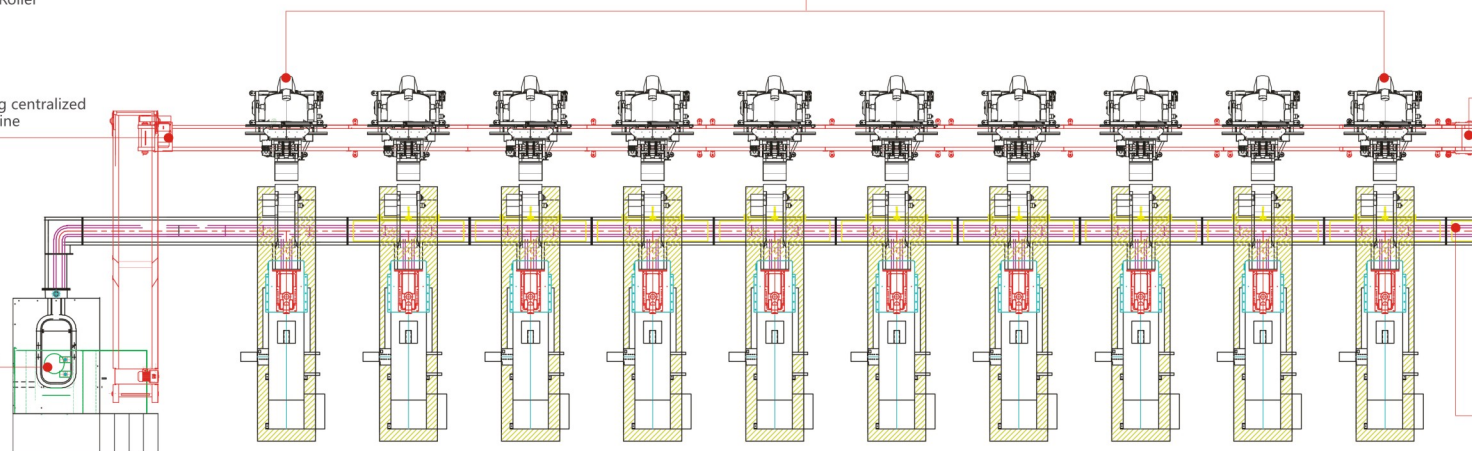

中央熔炉锌合金自动化压铸生产线
Automatic die casting line for zinc alloy in central furnace

热室系列控制特点

Features of Hot Chamber Die Casting Machines Series

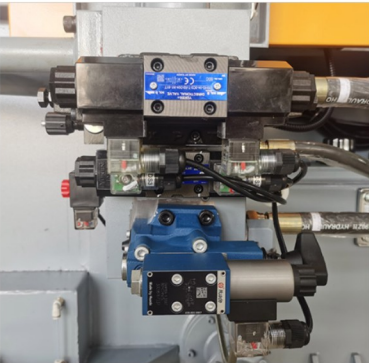

先导式溢流控制液压系统
Pilot overflow control hydraulic system

智能动态运转、节能率高、清除高压节流、降低油温。
Intelligent dynamic operation, high energy-saving rate, high pressure throttling, low oil temperature.

压射系统
Injection system

- 采用一个独立的高速储能器,有充足的储压容量,保证稳定的压射力。
- 宽幅的压射速度调整范围。
- 高速压射最大空压射速度稳定,生产高品质铸件的保证。
- 油压冲击小,重复精度高,适合生产高致密铸件。
- 气囊和活塞式储能结构,提高动作反应,改善压射系统的整体性,减少漏油点。
- An independent high-speed accumulator with sufficient pressure storage capacity ensures a stable injection force.
- Wide range of injection speed adjustment.
- High-speed injection maximum air injection speed stability, production of high-quality castings guarantee.
- Low oil pressure impact, high repeat precision, suitable for production of high-density castings.
- Air Bag and piston type energy storage structure, improve action response, improve the integrity of the injection system, reduce oil leakage points.



电器控制系统
Electrical control system

- 为了满足不同地区客户的需求,控制系统和触摸屏分别有不同选项供客户选择:西门子、台达或欧姆龙控制系统;西门子、台达或威纶触摸屏。方便操控,丰富的各项功能页面,满足压铸工艺的调控。
- 强大参数储存功能,方便以后生产调用,提高生产效率,保持产品质量一致。
- 机身线路采用耐油耐温且外包钢丝护网电线,即使在恶劣的环境都很好防护,保证正常生产。
- 独特的旋转落料斗位置选择,可供客户根据厂房情况选择更好的落料方式。
- In order to meet the needs of customers in different regions, the control system and touch screen have different options for customers to choose: Siemens, Delta or Omron control system; Siemens, delta or Vallon touch screen. Easy to control, a wealth of functional pages to meet the die-casting process, the regulation.
- Powerful parameter storage function, convenient for later production call, improve production efficiency, keep product quality consistent.
- The fuselage line adopts oil-resistant and heat-resistant wire wrapped with steel wire mesh, even in bad environment, it is well protected to ensure normal production.
- Unique position selection of rotary blanking Hopper, allowing customers to choose a better blanking method according to plant conditions.



锁模系统
Mold Clamping System

- 四条大杠立柱,采用高拉力钢为原材料,表面再经高频热处理加硬、外层再电镀硬铬、高耐磨性、延长机械使用寿命。
- 三大模板和机铰采用高强度球墨铸铁,曲肘连杆五点扩力结构,提供强大的锁模力。
- 锁模动作分多级压力和速度控制及低压锁模保护功能。
- 油缸液顶出设计,提供平衡的顶出力,减少产品顶出变形的因素。
- 采用中央电动润滑系统,先进的逐点定量式润滑,保证远近各润滑点润滑均匀,而且有液位及压力报警功能,确保机器良好的润滑效果。
- 机器配置模具冷却水接口,方便安装操作。
- Four tie bars using high-tension steel as raw material, the surface is hardened by high-frequency heat treatment, the outer layer is re-plated with hard chromium, high abrasion resistance, and prolong the service life of the machine.
- High strength nodular cast iron is used in the three platens and toggle and the five-point expanding force structure of the connecting rod is used to provide strong clamping force.
- Multi-stage pressure and speed control and low-voltage mold-locking protection.
- Cylinder hydraulic ejector design, to provide a balanced ejection force, reduce the product ejection deformation factors.
- Central electric lubrication system, advanced point-by-point quantitative lubrication, to ensure that all points near and far lubrication uniform, and liquid level and pressure alarm function, to ensure good machine lubrication effect.
- The machine is equipped with mould cooling water contact for easy installation and operation.



液压系统
Hydraulic System

- 采用一个独立的高速储能器,有充足的储压容量,保证稳定的压射力。
- 压射速度可单独控制,反应灵敏、动作平稳。
- 压射动作由一段速控制,配合特定的波压系统,适用各种表面要求较高的产品工艺要求。
- 宽幅的压射速度调整范围。
- 高速压射最大空压射速度稳定,生产高品质铸件的保证。
- 油压冲击小、重复精度高,适合生产高致密铸件。
- 气囊式储能结构,提高动作反应速度,改善压射系统的整体生产效率和产品质量要求。
- 采用快速锁模油路系统,提高生产效率。
- 使用可靠品牌液压元件(东京计器、油研等品牌)。
- An independent high-speed accumulator with sufficient pressure storage capacity ensures a stable injection force.
- The injection speed can be controlled separately, the reaction is sensitive and the action is stable.
- Injection action by a speed control, with a specific wave pressure system, suitable for a variety of surface requirements of the product process requirements.
- Wide range of injection speed adjustment.
- High-speed injection maximum air injection speed stability, production of high-quality castings guarantee.
- Low oil pressure impact, high repeat precision, suitable for the production of high-density castings.
- The capsule energy storage structure can improve the action reaction speed, improve the overall production efficiency and product quality requirements of the injection system.
- Adopt fast mode-locking oil circuit system to improve production efficiency.
- The use of reliable brand hydraulic components (Tokyo Keiki, Yuken and other brands).



热室系列模板尺寸图

Platen Drawing of DM Series Hot Chamber Die Casting Machines

DM25T 模板图

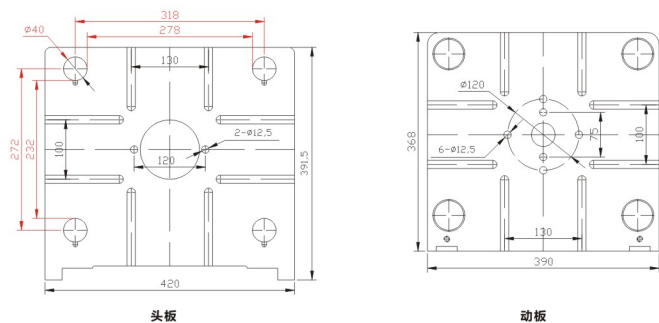

DM28T 模板图

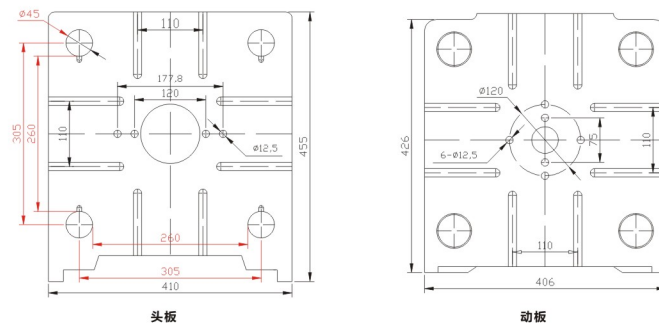

DM30T 模板图

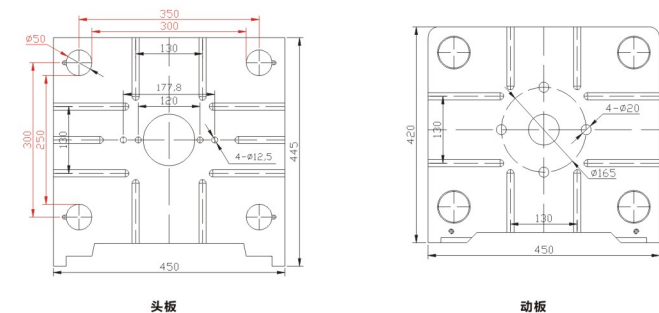

※ 备选项 我司保留权利作出任何技术数据修改而不另行通知。
机器外型尺寸不包括熔炉及控制柜。

Our company reserves the right to make any data changes without notice.
Size of the machine not includes furnace and control box.

DM38T 模板图

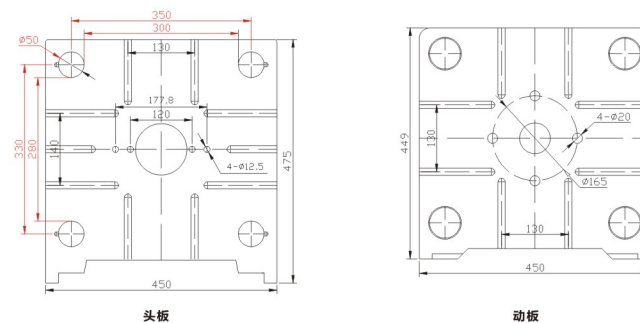

DM50T 模板图

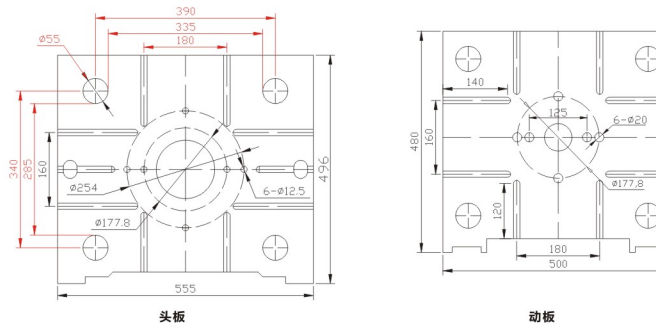

DM50TC 模板图

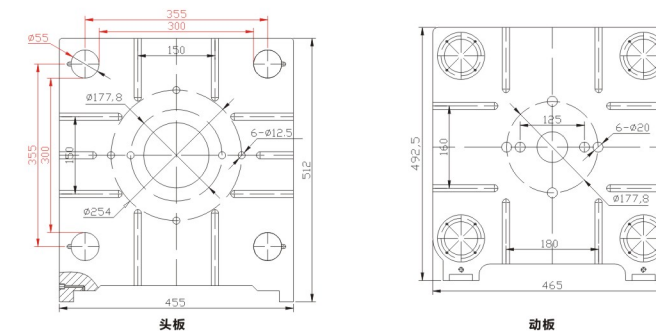

※ 备选项 我司保留权利作出任何技术数据修改而不另行通知。
机器外型尺寸不包括熔炉及控制柜。

Our company reserves the right to make any data changes without notice.
Size of the machine not includes furnace and control box.

热室系列模板尺寸图

Platen Drawing of DM Series Hot Chamber Die Casting Machines

DM68T 模板图

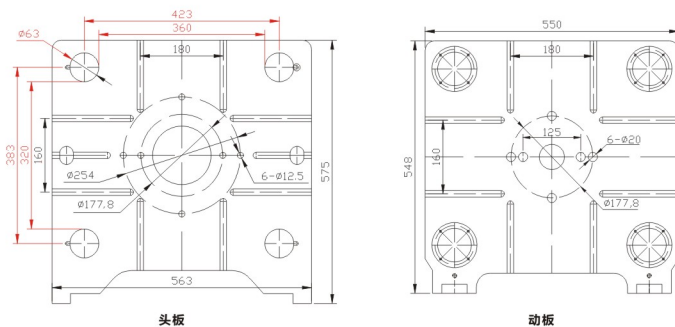

头板

动板

DM90T 模板图

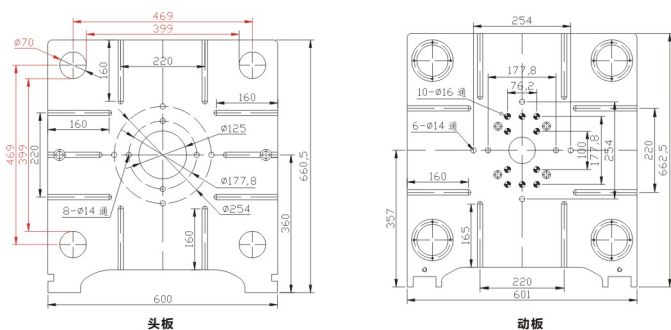

头板

动板

DM100T 模板图

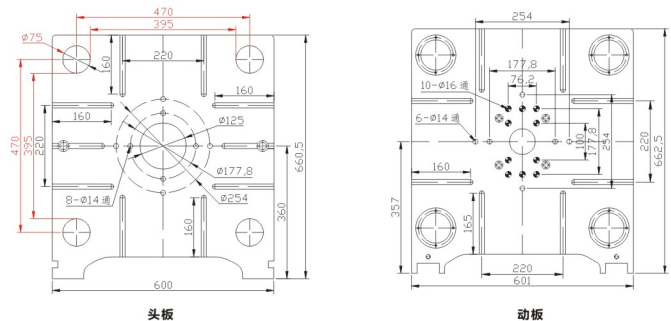

头板

动板

※ 备选项 我司保留权利作出任何技术数据修改而不另行通知。
机器外型尺寸不包括熔炉及控制柜。

Our company reserves the right to make any data changes without notice.
Size of the machine not includes furnace and control box.

DM138T 模板图

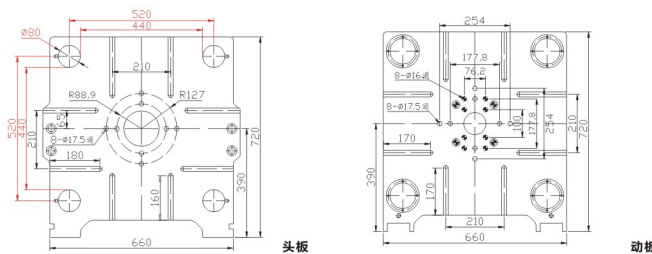

头板

动板

DM168T 模板图

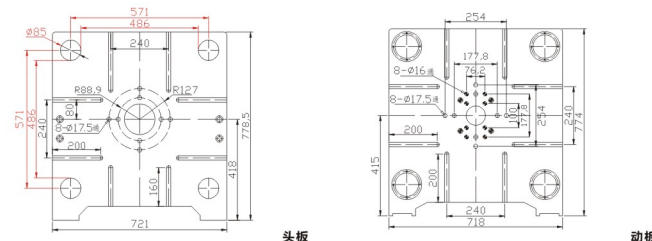

头板

动板

DM300T 模板图

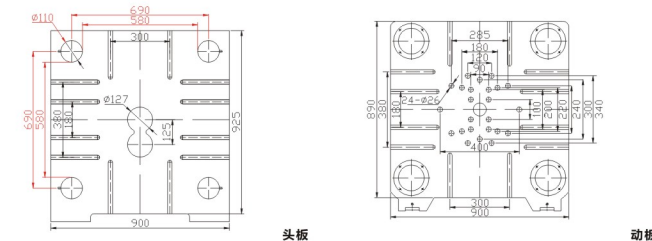

头板

动板

DM400T 模板图

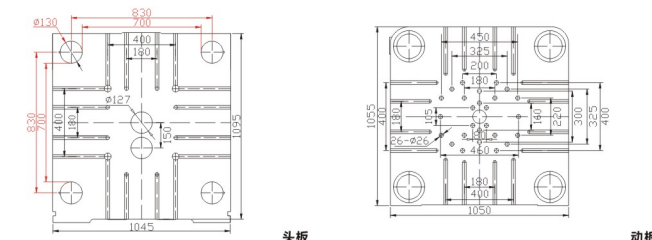

头板

动板

※ 备选项 我司保留权利作出任何技术数据修改而不另行通知。
机器外型尺寸不包括熔炉及控制柜。

Our company reserves the right to make any data changes without notice.
Size of the machine not includes furnace and control box.

DM热室压铸机技术参数表
Technical Parameters of DM Series Hot Chamber Die Casting Machines

配置项目 Item	单位 UNIT	DM25T	DM28T	DM30T	DM38T	DM50T	DM50TC	DM68T	DM90T	DM100T	DM138T	DM168T	DM200T	DM280T	DM400T
合模力 Clamping Force	KN	250	280	300	380	500	500	680	900	1000	1380	1680	2000	2800	4000
合模行程 Clamping stroke	mm	135	165	190	190	215	215	215	300	300	350	360	400	460	550
顶出力 Ejecting Force	KN	25	25	35	35	40	40	40	63	70	90	108	150	150	285
顶出行程 Ejection Stroke	mm	40	40	45	45	45	45	45	60	60	85	85	100	105	125
模具厚度 Mold thickness	mm	120-210	120-250	120-300	120-300	120-330	120-330	120-330	130-430	130-430	170-490	200-520	220-600	250-700	250-700
模板尺寸 Platen Size (W*H)	mm	390x370	4 10*410	450x400	450x430	550x435	455x455	565x500	600x660	600x660	660x720	720x770	820x820	900x900	1050x1050
导柱间距 Tie bar spacing(W*H)	mm	278x232	260*260	300x250	300x280	335x285	300x300	360x320	399x399	395x395	440x440	486x486	530x530	580x580	700x700
导柱直径 Tie bar Diameter	mm	40	45	50	50	55	55	63	70	75	80	85	100	110	130
射料位置 Injection Position	mm	0	0	0	0	0	0	0	0	0	0/-80	0/-80	0/-125	0/-125	0/-150
射料力 Injection Force	KN	30	30	50	50	55	55	60	65	75	108	108	130	160	180
射料行程 Injection Stroke	mm	85	85	105	105	110	110	110	130	130	145	150	175	200	230
离咀行程 Stroke far from nozzle	mm	0-280	0-330	0-330/270	0-330/270	0-330/270	0-330/270	0-330/270	270	270	280	280	320	320	400
锤头直径 Plunger diameter	mm	38	38	42	42	45	45	45	45/50/55	45/50/55	60/65	60/65/70	60/65/70	70/80	70/80/90
射料量/锌 Shot Weight/Zinc	Kg	0.38	0.38	0.7	0.7	0.9	0.9	0.9	1.0/1.26/1.53	1.0/1.26/1.53	2.1/2.4	2.1/2.4/2.86	2.5/2.9/3.3	3.8/5	4.4/5.5/7.2
坩埚容量/锌 Crucible Capacity / Zinc	Kg/Zn	150	200	360	360	360	360	480	480	480	480	480	480	480	480
电机功率 Motor Power	KW	5.5	5.5	7.5B	7.5B	7.5B	7.5B	7.5B	11	11	15	15	15	18.5	22
系统工作压力 System pressure	MPa	8	8	8.5	8.5	8.5	8.5	9	10.5	12	13	13	14	14	14
熔炉 Furnace consumption (Oil)	Kg/h	1.8	1.8	3.5	3.5	3.5	3.5	3.5	4.8	4.8	4.8	4.8	6.3	6.3	11.2
电炉 Furnace consumption (Electric)	Kw	12	12	18	18	18	18	18	30	30	30	30	42	42	70
油箱容量 Oil Tank Capacity	L	200	200	200	200	200	200	200	250	250	300	300	400	500	800
射咀加热功率 Nozzle Heating power	Kw	1.5	1.5	1.5	1.5	2	2	2	2	2	2.5	2.5	4	5	5
料杯机尺寸 Size of Machine (Fast Cup Type)	mm	2920*1450*1750	2920*1450*1750	2980*1450*1920	2980*1450*1920	3230*1500*2030	3230*1500*2030	3300*1580*2060							
料壶机尺寸 Size of Machine (Fast Pot Type)	mm		3120*1530*1980	3120*1530*1980	3120*1530*2000	3150*1530*2020	3150*1530*2020	3150*1580*2060	4200*1450*2050	4200*1450*2050	4850*1600*2240	4850*1600*2270	5300*1850*2550	5600*1850*2650	6900*2100*2860

※ 备选项 我司保留权利作出任何技术数据修改而不另行通知。
机器外型尺寸不包括熔炉及控制电脑。

Our company reserves the right to make any data changes without notice.
Size of the machine not includes furnace and control box .

※ 备选项 我司保留权利作出任何技术数据修改而不另行通知。
机器外型尺寸不包括熔炉及控制电脑。

Our company reserves the right to make any data changes without notice.
Size of the machine not includes furnace and control box .